

# BUILD-TO-LEASE LAND

4907 Interstate Blvd. Loves Park, IL

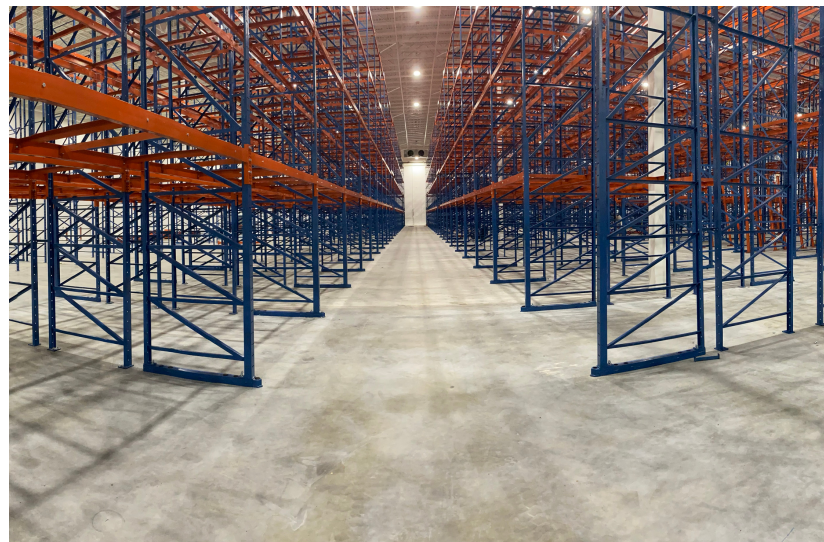
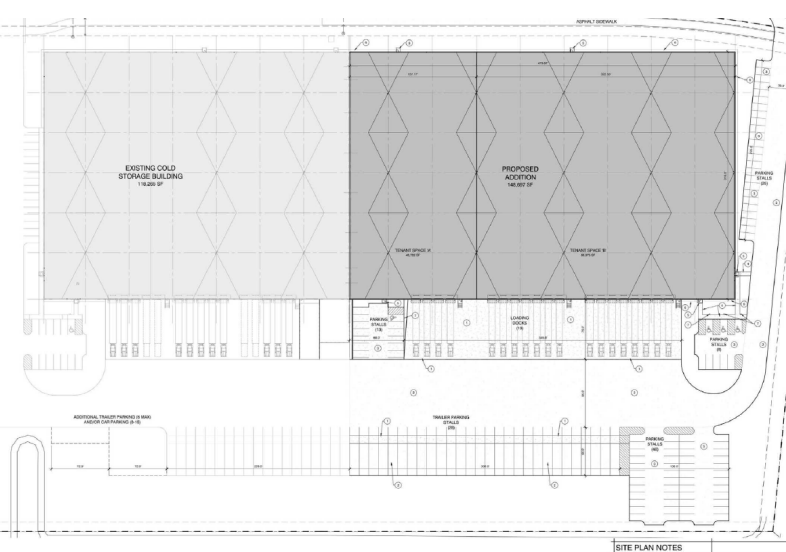

## Facility Specs

**Available Space:** 148,697 SF (divisible to 50,000 SF)

**Type:** Ambient, Cold, or Freezer

**Ceiling Height:** 35' Clear

**Column Spacing:** 54' 6" x 50'

**Sprinklers:** ESFR

**Office:** To suit

**Dock Doors:** 19 Docks, 1 Potential Drive-in

**Access:** I-90/39

## Contact Us

Jamie Sager

Manager of Real Estate & Leasing

[JamieSa@wowlogistics.com](mailto:JamieSa@wowlogistics.com)

(920)415-3745



# LOCATION DETAILS

4907 Interstate Blvd



## Advantages

Located two miles from I-90 via Riverside Road

Nineteen minutes from Chicago-Rockford International Airport

Located in Northern Illinois Premier Business Park

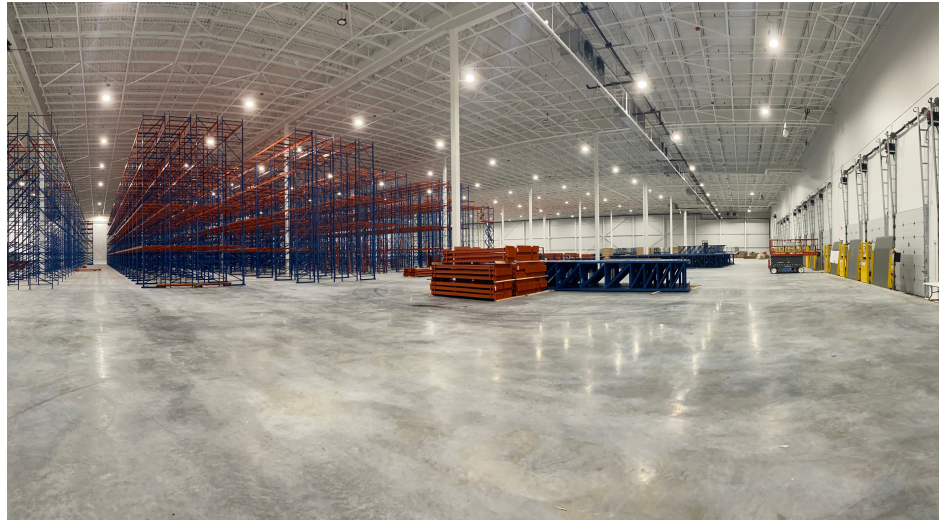

## Driving Distances to Major Cities

**Madison:** 68 miles/1 hour, 7 minutes

**Milwaukee:** 89 miles/1 hour, 21 minutes

**Chicago:** 83 miles/1 hour, 32 minutes

**Green Bay:** 195 miles/3 hours, 3 minutes

**Minneapolis:** 328 miles/4 hours, 47 minutes



## Contact Us

Jamie Sager

Manager of Real Estate & Leasing

[JamieSa@wowlogistics.com](mailto:JamieSa@wowlogistics.com)

(920)415-3745