



3605 Conord Ave | Schofield, WI

Total building: 330,000 SF

Total available: Building 5 - 75,000 SF
Building 7 - 106,250 SF

Available: Upon 30-day notice

Year built: Building 5 - 1988
Building 7 - 1998

Loading: Building 5 - 6 Docks, 2 Drive-in
Building 7 - 10 Docks, 2 Drive-in

Clear Height: Building 5 - 27'-2" Peak, 23' Eave
Building 7 - 32'9" Peak, 27' Eave

Power: 400 amp, 3-phase

Fire Protection: CMDA Storage Application

Zoning: Limited Industrial

Parcel number: 119228081710969 &
19228081710970

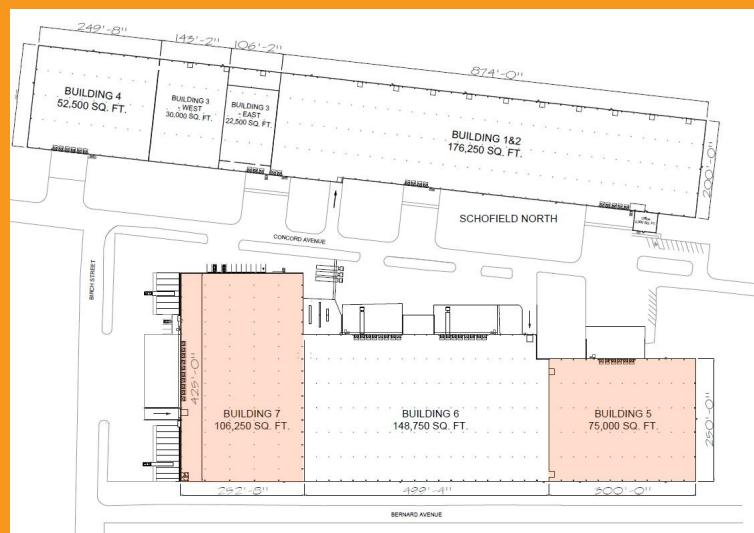

Contact Us

Jamie Sager | Manager of Real Estate and Leasing
JamieSa@wowlogistics.com
 (920)415-3745

